

Tsurugi Synthesis Cultural Center "Crane"

77 Shichihara-machi, Hakusan 920-2143
 TEL: 076-273-8700 FAX: 076-273-8701
 E-mail: cranehall@city.hakusan.ishikawa.jp



Culture hall



■ Number of seats
805 seats (Culture hall)
 (General seat: 798, Wheelchair space: 7)



■ Traffic access
 50 min by bus from JR Kanazawa Station for Shimomorishima (Get off at Shichihara and walk for 2 min.)
 Hokuriku Railroad Ishikawa Line (Get off at Dohoji and walk for 30 min.)



■ Hours
 9:00am~10:00pm
 Closed: Monday (the following weekday when Monday is a holiday), Year-end and New Year's holidays (Dec. 27~Jan. 4)

■ Date to start accepting reservation
 Culture hall and related facilities: one year before
 Lifelong learning area (Workshop rooms): three months before



■ Accommodation
 None



■ Restaurants/Cafés
 Coffee shop "Gion": 35 seats



■ Parking
 400 vehicles (free)



■ Remarks
 None

Floor plan

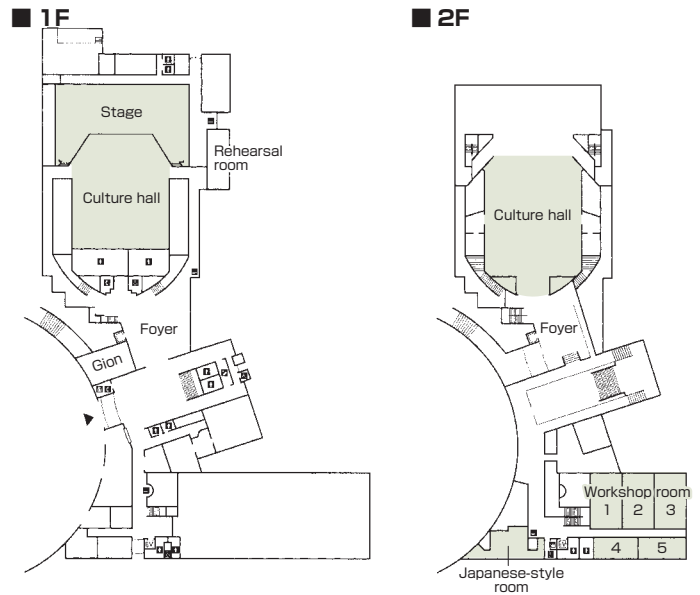

■ Convention site

Site name	Floor	Area(m ²)	Width × Depth (m) (m)	Ceiling height(m)	Capacity (persons)					Remarks
					Fixed seats	School	Theater	Seated	Buffet	
Culture hall	1	—	—	—	805	—	—	—	—	Wheelchair space: 7
Workshop room1	2	100	7.5 × 13.0	4	—	60	—	—	—	Workshop room 1 ~ 3 can be integrated into one space.
Workshop room2	2	100	7.5 × 13.0	4	—	60	—	—	—	
Workshop room3	2	100	7.5 × 13.0	4	—	60	—	—	—	
Workshop room4	2	55	11.0 × 5.0	4	—	30	—	—	—	
Workshop room5	2	55	11.0 × 5.0	4	20	—	—	—	—	
Japanese-style room	2	25-tatami-mat	9.0 × 5.0	2	—	—	—	—	—	

Width × Depth and the floor area may not match depending on the shape of the room.