

# 13 Kanazawa Workers Plaza

3-2-20 Kitayasue, Kanazawa 920-0022  
 TEL: 076-221-7771 FAX: 076-221-7991  
 URL: <http://www.kinpura.com>



Workshop room 101



Workshop room 304 / Workshop room 305



■ Number of seats  
**400** seats (Multipurpose room)



■ Traffic access  
 10-min walk from JR Kanazawa Station, Kanazawa Port Exit (West exit)



■ Hours  
 9:00am~9:00pm  
 (Sun. and national holiday: 9:00am~5:00pm)  
 Closed: 1st Tue., year-end and New Year's holidays (Dec. 29~Jan. 3)

■ Date to start accepting reservation  
 Beginning of the month three months before the date of use (For some rooms, one year before)



■ Accommodation  
 None



■ Restaurants/Cafés  
 None



■ Parking Capacity  
**190** vehicles (pay) (Room users are discounted)



■ Remarks  
 Cooking class room, music room, Japanese-style room

■ Convention site

| Site name               | Floor | Area (m <sup>2</sup> ) | Width × Depth (m) | Ceiling height (m) | Capacity (persons) |        |         |        |        | Remarks              |
|-------------------------|-------|------------------------|-------------------|--------------------|--------------------|--------|---------|--------|--------|----------------------|
|                         |       |                        |                   |                    | Fixed seats        | School | Theater | Seated | Buffet |                      |
| Workshop room 101       | 1     | 127                    | 12.0 × 10.5       | 2.8                | —                  | 84     | —       | —      | —      |                      |
| Workshop room 102       | 1     | 23                     | 6.3 × 3.6         | 2.6                | —                  | 12     | —       | —      | —      | Square-shaped layout |
| Workshop room 103       | 1     | 58                     | 9.8 × 5.9         | 2.6                | —                  | 42     | —       | —      | —      |                      |
| Meeting room 201        | 2     | 57                     | 10.0 × 5.7        | 2.6                | 20                 | —      | —       | —      | —      | Boat-shaped table    |
| Workshop room 202       | 2     | 48                     | 9.5 × 5.0         | 2.5                | —                  | 20     | —       | —      | —      |                      |
| Workshop room 203       | 2     | 48                     | 9.5 × 5.0         | 2.6                | —                  | 24     | —       | —      | —      |                      |
| Workshop room 204       | 2     | 76                     | 9.8 × 7.6         | 2.6                | —                  | 30     | —       | —      | —      |                      |
| Workshop room 205       | 2     | 76                     | 9.8 × 7.6         | 2.6                | —                  | 30     | —       | —      | —      |                      |
| Meeting room 301        | 3     | 57                     | 10.0 × 5.7        | 2.6                | 16                 | —      | —       | —      | —      | Boat-shaped table    |
| Workshop room 302       | 3     | 48                     | 9.5 × 5.0         | 2.6                | —                  | 20     | —       | —      | —      |                      |
| Workshop room 303       | 3     | 48                     | 9.5 × 5.0         | 2.6                | —                  | 24     | —       | —      | —      |                      |
| Workshop room 304       | 3     | 76                     | 9.8 × 7.6         | 2.6                | —                  | 36     | —       | —      | —      |                      |
| Workshop room 305       | 3     | 76                     | 9.8 × 7.6         | 2.6                | —                  | 36     | —       | —      | —      |                      |
| Japanese-style room 306 | 3     | 48-tatami-mat room     | 11.9 × 7.1        | 2.7                | —                  | 90     | —       | —      | —      | With a stage         |
| Workshop room 401       | 4     | 30                     | 6.0 × 5.0         | 2.6                | —                  | 12     | —       | —      | —      | Soundproofed         |
| Japanese-style room 402 | 4     | 21-tatami-mat room     | 8.2 × 4.6         | 2.4                | —                  | 18     | —       | —      | —      |                      |
| Japanese-style room 403 | 4     | 12.5-tatami-mat room   | 4.6 × 4.6         | 2.4                | —                  | 8      | —       | —      | —      |                      |
| Workshop room 406       | 4     | 92                     | 12.3 × 7.2        | 2.6                | —                  | 42     | —       | —      | —      |                      |
| Workshop room 407       | 4     | 25                     | 6.2 × 4.1         | 2.6                | —                  | 12     | —       | —      | —      | Square-shaped layout |

Width × Depth and the floor area may differ depending on the shape of the room.

# Floor plan

## 1F

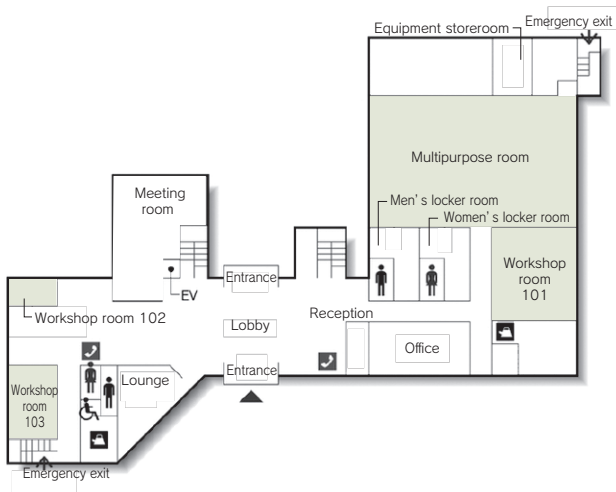

## 2F

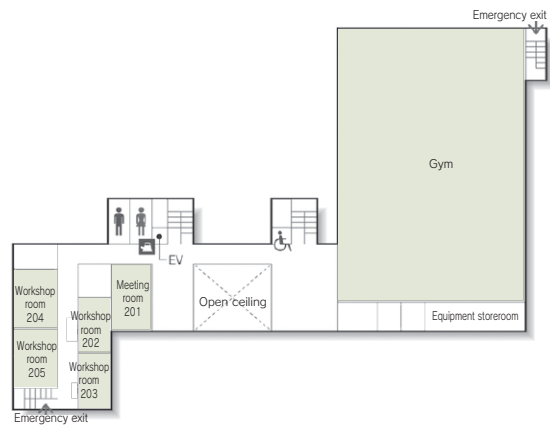

## 3F

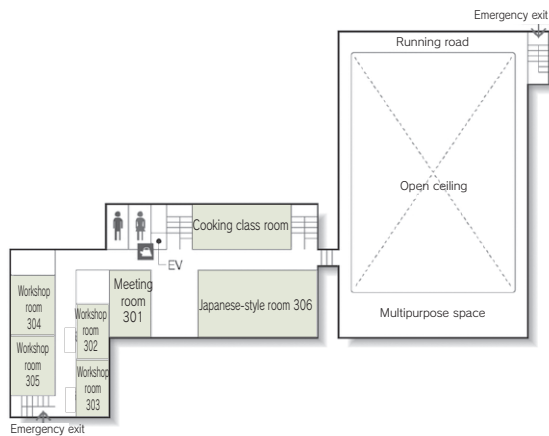

## 4F

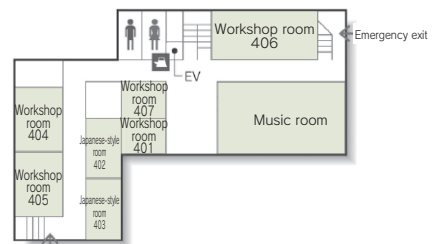

### Convention site

| Site name          | Floor | Area (m <sup>2</sup> ) | Width × Depth (m) | Ceiling height (m) | Capacity (persons) |         |         |        |        | Remarks   |
|--------------------|-------|------------------------|-------------------|--------------------|--------------------|---------|---------|--------|--------|---|
|                    |       |                        |                   |                    | Fixed seats        | Lecture | Theater | Seated | Buffet |   |
| Multipurpose room  | 1     | 507                    | 27.0 × 18.3       | 3.2                | —                  | 240     | 400     | —      | —      |   |
| Gym                | 2     | 1,101                  | 26.9 × 40.5       | 12.5               | —                  | —       | 600     | —      | —      |   |
| Cooking class room | 3     | 92                     | 11.9 × 7.1        | 2.8                | 36                 | —       | —       | —      | —      |   |
| Music room         | 4     | 130                    | 15.1 × 8.0        | 2.7                | —                  | 80      | —       | —      | —      | Piano, Soundproofed   |
| Meeting room       | 1     | 37                     | 5.4 × 6.8         | 3.2                | —                  | 16      | —       | —      | —      | Square-shaped layout<br>(There is a pillar in the center of the room) |
|                    |       |                        |                   |                    |                    |         |         |        |        |   |
|                    |       |                        |                   |                    |                    |         |         |        |        |   |
|                    |       |                        |                   |                    |                    |         |         |        |        |   |
|                    |       |                        |                   |                    |                    |         |         |        |        |   |
|                    |       |                        |                   |                    |                    |         |         |        |        |   |

Width × Depth and the floor area may differ depending on the shape of the room.