

Komatsu Chamber of Commerce and Industry

Small and Medium Enterprises Seminar House

Ni-1 Sono-machi, Komatsu 923-8566
 TEL: 0761-21-3121 FAX: 0761-21-3120
 URL: <https://komatsu-cci.or.jp/>



3FLarge hall(Large conference room)



■ Number of seats

200 seats (3F large hall in school style)
440 seats (3F large hall in theater style)



■ Traffic access

10 min by bus from JR Komatsu Station (Get off at Komatsu Shokokaigisho-mae and walk for 1 min.)
 5 min by taxi from JR Komatsu Station



■ Hours

9:00am~9:00pm (Weekday)
 9:00am~5:00pm (Sat, Sun, holiday)
 Closed: Year-end and New Year's holidays (Dec. 29~Jan. 3)

■ Date to start accepting reservation

At any time



■ Accommodation

None



■ Restaurants/Cafés

None



■ Parking

80 vehicles (free)



■ Remarks

None

Floor plan

■ 1F

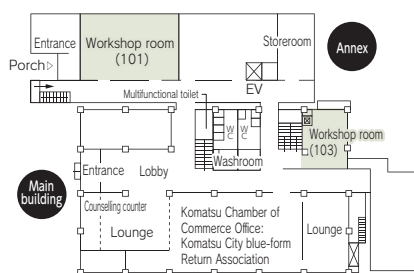

■ 3F

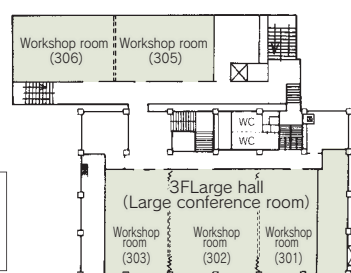

■ 4F

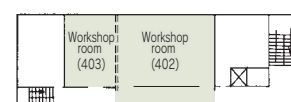

■ Convention site

Site name	Floor	Area(m ²)	Width × Depth (m)	Ceiling height(m)	Capacity (persons)					Remarks
					Fixed seats	School	Theater	Seated	Buffet	
101	1	81	10.7 × 7.6	3.0	—	42	56	—	—	
103	1	39	7.5 × 5.4	2.5	—	16	20	—	—	
3FLarge hall(Large conference room)	3	339	26.0 × 13.0	4.0	—	200	440	—	—	With a stage, the space can be partitioned into three rooms.
305, 306	3	162	23.1 × 7.0	3.0	—	102	200	—	—	The space can be partitioned into two rooms.
402	4	81	10.8 × 7.5	3.0	—	42	40	—	—	
403	4	40	7.0 × 5.8	3.0	—	16	20	—	—	

Width × Depth and the floor area may not match depending on the shape of the room.