

# 1 Kanazawa Bunka Hall

15-1 Takaoka-machi, Kanazawa 920-0864  
 TEL: 076-223-1221 FAX: 076-223-1299  
 URL: <https://www.bunka-h.gr.jp>



Concert Hall



Multipurpose room



■ Number of seats  
**899** seats (Hall) , Orchestra pit 59m<sup>2</sup>



■ Traffic access  
 15-min bus ride from JR Kanazawa Station (Get off at Minami-cho/Oyama Shrine and walk for 3 min.)  
 10 min by taxi from JR Kanazawa Station



■ Hours  
 9:00am~10:00pm  
 Closed: 2nd and 4th Wed. of the month  
 (Days may change depending on events.)  
 Year-end and New Year's holidays (Dec. 29~Jan. 3)

■ Date to start accepting reservation  
 Beginning of the month one year before the date of use



■ Accommodation  
 None



■ Restaurants/Cafés  
 None



■ Parking Capacity  
 None



■ Remarks  
 Japanese Tearoom "Kansei-an"  
 7 dressing rooms, 4 practice rooms

## ■ Convention site

| Site name                                  | Floor | Area (m <sup>2</sup> ) | Width×Depth (m) (m) | Ceiling height (m) | Capacity (persons) |        |         |        |        | Remarks  |
|--|-------|------------------------|---------------------|--------------------|--------------------|--------|---------|--------|--------|--|
|  |       |                        |                     |                    | Fixed seats        | School | Theater | Seated | Buffet |  |
| Hall                                       | —     | 868                    | —                   | —                  | 899                | —      | —       |        |        | 1st floor: 800 seats, 2nd-floor: 99 seats, 4 wheelchair spaces       |
| Assembly Room (entire room)                | 2     | 440                    | 14.3×31.3           | 2.3~3.3            | —                  | 160    | 400     |        |        |  |
| Assembly Room (Area 1)                     | 2     | 273                    | 14.3×19.5           | 2.3~3.3            | —                  | 88     | 220     |        |        |  |
| Assembly Room (Area 2)                     | 2     | 167                    | 14.3×11.4           | 2.3~3.3            | —                  | 48     | 130     |        |        |  |
| Conference Room 1                          | 2     | 31                     | 5.2×6.0             | 2.6                | 12                 | —      | —       |        |        | Oval-shaped table  |
| Conference Room 2                          | 2     | 48                     | 5.2×9.4             | 2.6                | 20                 | —      | —       |        |        | Oval-shaped table  |
| Conference Room 3                          | 3     | 31                     | 5.2×6.0             | 2.4                | —                  | 14     | —       |        |        |  |
| Conference Room 4                          | 3     | 47                     | 5.2×9.0             | 2.4                | 8                  | —      | —       |        |        | Lounge suite   |
| Conference Room 5                          | 3     | 64                     | 5.6×11.4            | 2.4                | —                  | 30     | —       |        |        | Two rooms can be joined for use as one room.                         |
| Conference Room 6                          | 3     | 64                     | 5.6×11.4            | 2.4                | —                  | 30     | —       |        |        |  |
| Large Conference Room (incl. Waiting Area) | 3     | 350                    | —                   | 2.8~3.8            | —                  | 99     | 210     |        |        |  |
| Lounge                                     | 3     | 36                     | 5.5×6.5             | 2.4                | 12                 | —      | —       |        |        | Oval-shaped table  |
| Japanese Tearoom                           | 1     | 131                    | —                   | —                  | —                  | —      | —       |        |        | 4.5-tatami-mat tearoom, 11-tatami-mat tearoom, chair seating tearoom |
| Gallery                                    | 1     | 300                    | —                   | 2.6~3.1            | —                  | —      | —       |        |        |  |
| Multipurpose room                          | 1     | 87                     | —                   | 2.6                | —                  | 36     | 60      |        |        |  |

Width × Depth and the floor area may differ depending on the shape of the room.

# Floor plan

## 1F

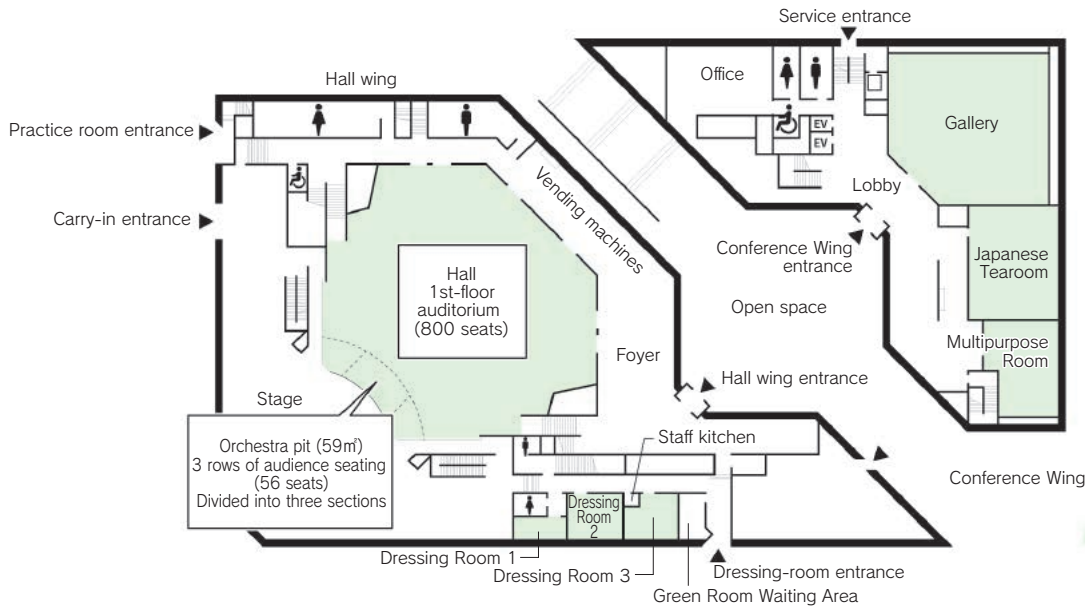

## 2F

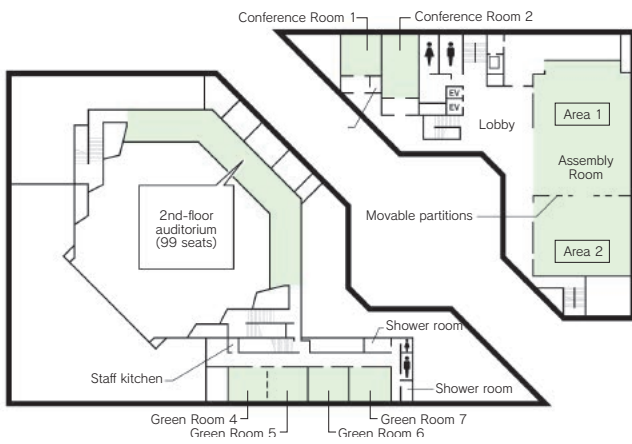

Assembly Room

## 3F

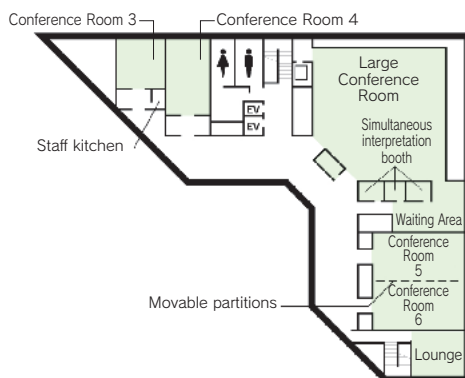

Large Conference Room