

1 KKR Hotel Kanazawa

2-32 Ote-machi, Kanazawa 920-0912
 TEL: 076-264-3261 FAX: 076-224-3608
 URL: <https://www.kkrhotelkanazawa.gr.jp/>

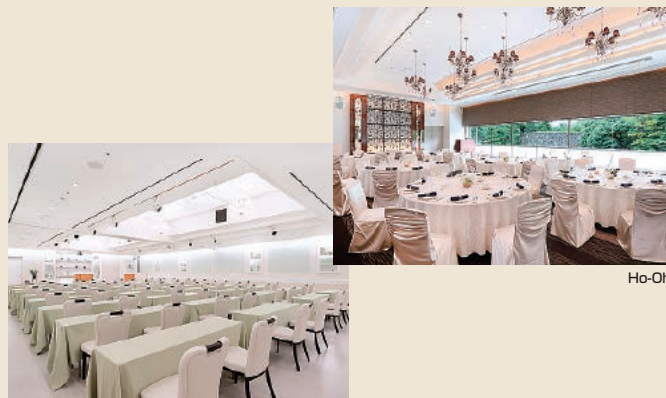

Ho-oh

Kujaku



■ Number of seats
500 seats (Ho-Oh)



■ Traffic access
 10-min bus ride from JR Kanazawa Station
 (Get off at Owari-cho and walk for 5 min.)
 8 min by taxi from JR Kanazawa Station



■ Hours
 9:00am~9:00pm

■ Date to start accepting reservation
 At any time



■ Accommodation
 • Single room: 34
 • Twin room: 40
 • Other room: 6
 Total: 80 rooms (131 people)



■ Restaurants/Cafés
 Restaurant "IBIS": 70 seats



■ Parking Capacity
46 vehicles (pay)



■ Remarks
 Internet available in all rooms

Floor plan

■ 3F

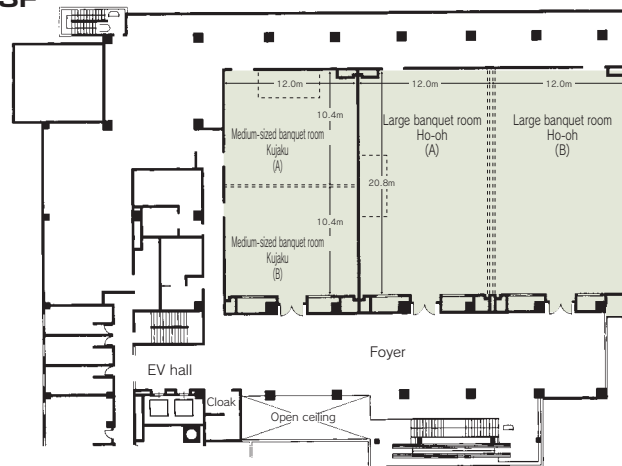

■ Convention site

Site name	Floor	Area (㎡)	Width×Depth (m) (m)	Ceiling height (m)	Capacity (persons)				Remarks	
					Fixed seats	School	Theater	Seated		Buffet
Ho-oh (entire room)	3	460	20.8×24.0	4.0	—	300	500	300	400	
Ho-oh (1/2)	3	225	20.8×12.0	4.0	—	150	300	132	180	
Kujaku (entire room)	3	225	20.8×12.0	2.8	—	150	300	132	150	
Kujaku (1/2)	3	110	10.4×12.0	2.8	—	60	100	60	60	
Nishiki (entire room)	2	50	—	—	—	27	50	27	30	
Izumi (entire room)	2	50	—	—	—	27	50	27	30	
Yayoi (entire room)	2	50	—	—	—	27	50	27	30	

Width × Depth and the floor area may differ depending on the shape of the room.