

1 Ishikawa Ongakudo

20-1 Showa-machi, Kanazawa 920-0856
 TEL: 076-232-8111 FAX: 076-232-8101
 URL: <https://ongakudo.jp>

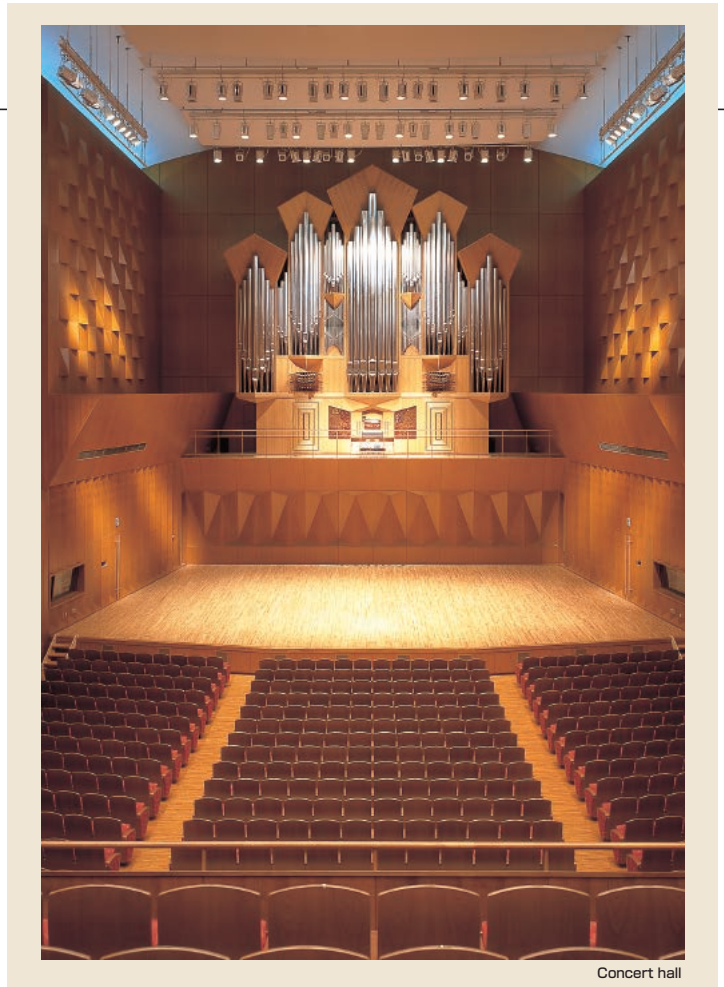

Concert hall



■ Number of seats
1,560 seats (Concert Hall)
720 seats (Hogaku Hall)
300 seats (Koryu Hall)



■ Traffic access
 1-min walk from JR Kanazawa Station, Kenrokuen Exit (East exit)



■ Hours
 9:00am~10:00pm
 Closed: Year-end and New Year's holidays (Dec. 29~Jan. 3)
 (In addition, the hall may be closed about 10 times a year for inspection.)

■ Date to start accepting reservation
 A lottery will be held from 10:30 am at the beginning of the month one year before the date of use. After the lottery, we accept reservations anytime.
 (the following day when the day is Sat, Sun or a holiday)



■ Accommodation
 None



■ Restaurants/Cafés
 Coffee shop "Café concerto"
 (Currently open only when an event is held)



■ Parking Capacity
152 vehicles (Paid, height limit applies)



■ Remarks
 Simultaneous interpretation booth
 (Concert Hall, Hogaku Hall)
 Pipe organ (Concert Hall)
 In general, eating and drinking are prohibited in the hall.

■ Convention site

Site name	Floor	Area (㎡)	Width×Depth (m) (m)	Ceiling height (m)	Capacity (persons)					Remarks
					Fixed seats	School	Theater	Seated	Buffet	
Concert hall	—	1,210	—	—	1,560	—	—	—	—	Shoe box
Dressing room A~D	2	20~40	—	3.0	—	—	—	—	—	
Dressing room E~J	3	20~51	—	3.0	—	—	—	—	—	
Hogaku Hall	—	585	—	—	720	—	—	—	—	Proscenium
Dressing room 1~4	2	16~111	—	2.8	—	—	—	—	—	
Japanese-style room	2	98	—	2.5	—	—	—	—	—	
Dressing room 5~9	3	30~52	—	2.5	—	—	—	—	—	
Practice room of Japanese music	3	100	—	2.7	—	—	—	—	—	
Koryu Hall	B1	520	20.0×26.0	8.4	—	180	300	—	—	
Waiting room 1, 2	B1	40-43	—	3.0	—	—	—	—	—	

Width × Depth and the floor area may differ depending on the shape of the room.

Floor plan



Hogaku Hall



Koryu Hall

1F floor plan

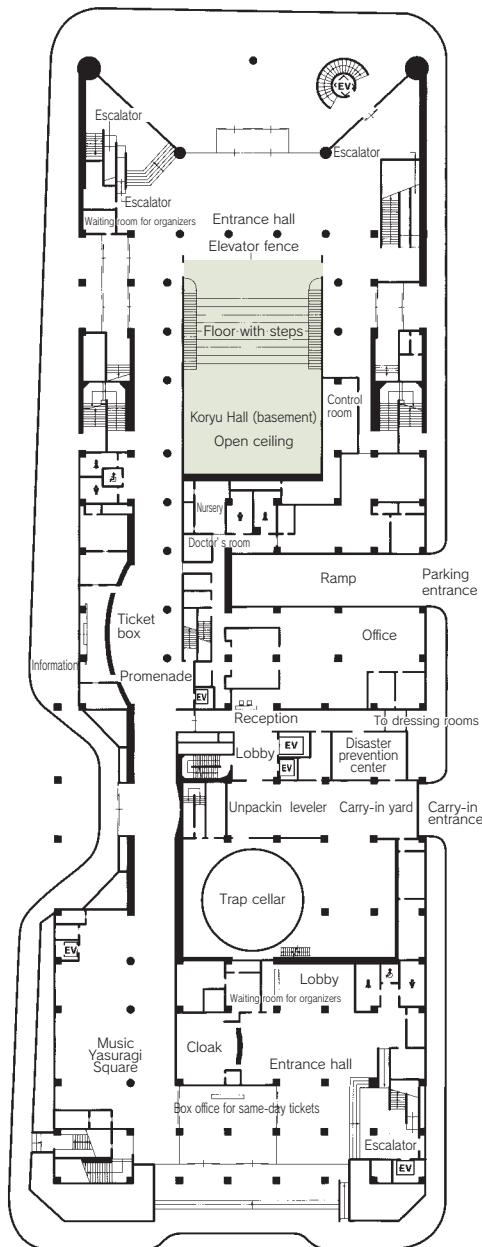

2F floor plan

