

# 3 Ishikawa Industrial Promotion Center

2-1 Kuratsuki, Kanazawa 920-8203  
 TEL: 076-268-2010 FAX: 076-268-2859  
 URL: <https://www.isico.or.jp/site/jibasan/>  
 E-mail: [jibasan@isico.or.jp](mailto:jibasan@isico.or.jp)



Main building



New building



Main building : Workshop room 1



■Number of seats  
**800** seats (Large hall)  
**300** seats (Convention hall)



■Traffic access  
 20-min bus ride from JR Kanazawa Station,  
 Kanazawa Port Exit (West exit)  
 (Get off at Kogyo-shikenjo.)  
 10 min by taxi from JR Kanazawa Station, Kanazawa  
 Port Exit (West exit)



■Hours  
 9:00am~9:00pm  
 Closed: Aug. 14~16, year-end and New Year's  
 holidays  
 (Dec. 29~Jan. 3)

■Date to start accepting reservation  
 Six months before the date of use



■Accommodation  
 None



■Restaurants/Cafés  
 Restaurant "I-Area Yuzen": 120seats  
 (Closed: Saturdays, Sundays and holidays  
 Tel:076-268-4595  
 11:00am ~ 3:00pm)



■Parking Capacity  
**722** vehicles (free)



■Remarks  
 None

## ■Convention site

Site name	Floor	Area (㎡)	Width×Depth (m) (m)	Ceiling height (m)	Capacity (persons)					Remarks
					Fixed seats	School	Theater	Seated	Buffet	
Main building Large hall	1	612	17.5×35.0	7.4	—	—	800	—	—	Movable seats: 482 seats
Meeting room 2	2	98	10.0× 8.0	2.9	32	—	—	—	—	
Meeting room 3	2	58	6.0× 8.0	2.9	20	—	—	—	—	
Special meeting room 5	1	143	11.0× 7.5	2.9	16	—	—	—	—	Provided with web conference equipment
Special meeting room 6	2	76	8.0× 8.0	2.8	16	—	—	—	—	
Meeting room 7	2	66	10.0× 5.0	2.7	28	—	—	—	—	
Meeting room 8	3	95	11.0× 7.5	2.9	36	—	—	—	—	
Training room 1	2	235	10.8×20.5	2.9	192	—	—	—	—	
Training room 2	2	139	10.8×11.7	2.9	96	—	—	—	—	
Training room 3	3	162	8.5×19.0	2.9	108	—	—	—	—	
Training room 4	3	100	7.5×11.5	2.9	72	—	—	—	—	
Training room 5	3	218	9.0×24.0	2.9	153	—	—	—	—	
Training room 6	3	108	9.0×12.0	2.9	54	—	—	—	—	
Training room 7	1	178	11.0×15.0	2.9	108	—	—	—	—	
New building Convention hall	1	402	20.1×19.7	6.2	—	—	300	—	—	Movable seats: 240 seats
Special meeting room 11	1	57	5.5× 6.5	2.8	7	—	—	—	—	
Special meeting room 12	1	57	5.5× 9.0	2.8	10	—	—	—	—	
Training room 10	2	190	8.8×22.0	2.8	104	—	—	—	—	
Training room 12	5	176	9.0×18.0	2.8	108	—	—	—	—	
Training room 13	5	118	9.0×12.0	2.8	54	—	—	—	—	

Width × Depth and the floor area may differ depending on the shape of the room.

# Floor plan

## Main building



Main building : Large hall

### 1F

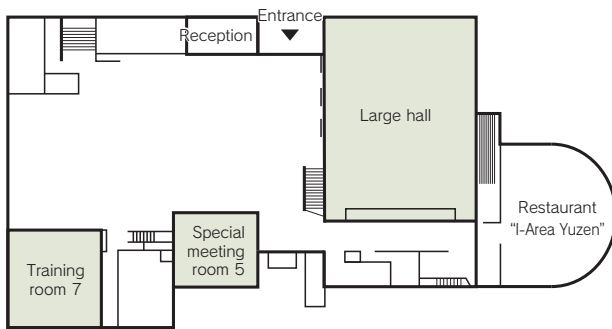

### 2F

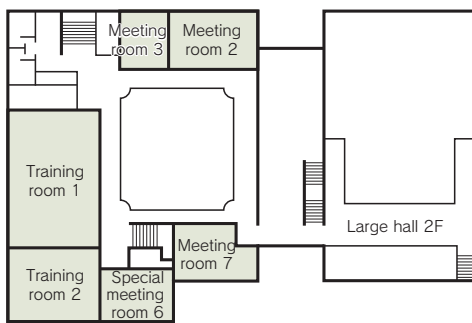

### 3F

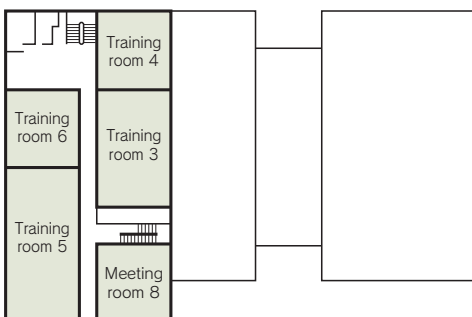

## New building



New building : Convention hall

### 1F

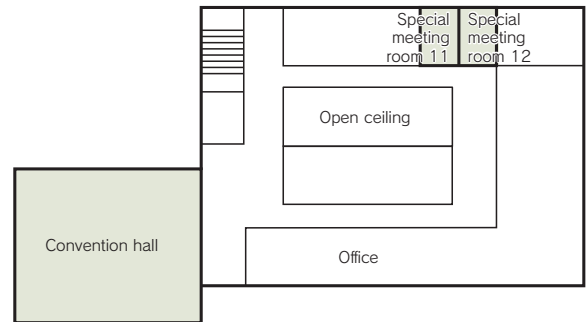

### 2F

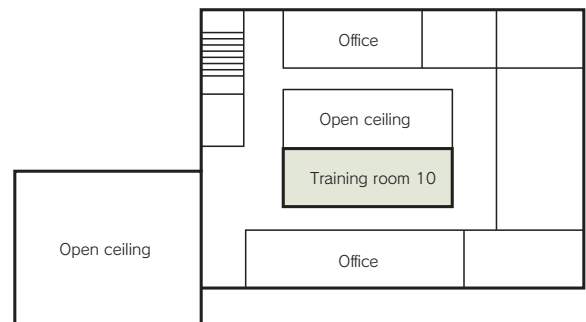

### 5F

