

Nanao City Cultural Hall

(Nanao Sunlife Plaza)

Wo-bu-38 Motofuchu-machi, Nanao 926-0021

Culture hall: Nanao City Sports Association

TEL: 0767-53-1160 FAX: 0767-53-3260

Plaza annex: Yatago Community Center

TEL: 0767-52-5240 FAX: 0767-52-5249



■ Number of seats

990 seats (Large hall)



■ Traffic access

4 min by bus from JR Nanao Station

(Get off at Sunlife Plaza and walk for 1 min.)

4 min by taxi from JR Nanao Station



■ Hours

9:00am~10:00pm

Closed: Monday, national holidays, year-end and New Year's holidays (Dec. 29~Jan. 3)

■ Date to start accepting reservation

Beginning of the month one year before the date of use



■ Accommodation

None



■ Restaurants/Cafés

None



■ Parking

260 vehicles (free)



■ Remarks

Library included



Large hall

Floor plan

■ 1F

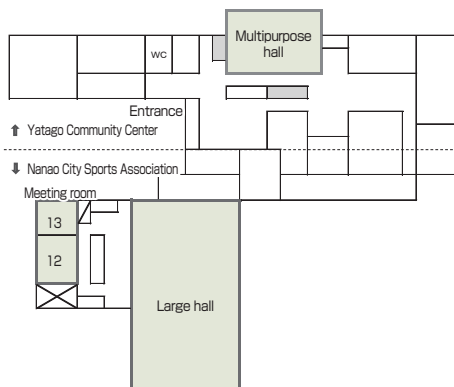

■ 2F

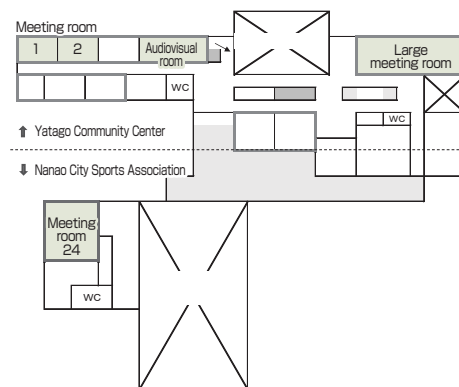

■ Convention site

Site name	Floor	Area(m²)	Width × Depth (m) (m)	Ceiling height(m)	Capacity (persons)					Remarks
					Fixed seats	School	Theater	Seated	Buffet	
Culture hall										
Large hall	1	—	—	7.0	990	—	—	—	—	
Meeting room 12	1	87	12.0 × 7.0	2.5	—	50	—	—	—	
Meeting room 13	1	67	7.5 × 9.5	2.5	—	30	—	—	—	
Meeting room 24	2	193	16.0 × 11.5	4.0	—	100	—	—	—	
Annex										
Multipurpose hall	1	350	19.0 × 18.0	7.4	—	—	—	—	—	You can arrange the room layout freely with 50 tables and 300 chairs.
Audiovisual room	2	231	11.0 × 21.0	2.7	200	—	—	—	—	
Large meeting room	2	292	11.0 × 24.0	2.7	—	—	—	—	—	
Meeting room 1	2	57	9.0 × 6.0	2.7	—	30	—	—	—	
Meeting room 2	2	57	9.0 × 6.0	2.7	—	30	—	—	—	

Width × Depth and the floor area may not match depending on the shape of the room.