

Tsubata Town Cultural Center “CYGNUS”

3-1 Kita-chujo, Tsubata-machi, Kahoku 929-0342

TEL: 076-288-8526 FAX: 076-288-8527

URL: <https://www.town.tsubata.lg.jp/page/1145.html>

E-mail: shougaikyouiku@town.tsubata.lg.jp



Hall

Floor plan



■ Number of seats

802 seats (Hall)

(Fixed seat: 784, Wheelchair space: 12, Parent and child seat: 6)



■ Traffic access

10 min walk from Tsubata Station of Ishikawa Railway and JR Nanao Line

10 min drive from Kanazawa-higashi IC of Hokuriku Expressway



■ Hours

9:00am~ 9:30pm

Closed: Monday (the following weekday when Monday is a holiday), year-end and New Year's holidays (Dec. 28~Jan. 4)

■ Date to start accepting reservation

Hall: Beginning of the month one year before the date of use

Rehearsal room or performer's waiting room only: Beginning of the month one month before the date of use

Other rooms: Beginning of the month three months before the date of use



■ Accommodation

None



■ Restaurants/Cafés

Coffee shop “Cygnus”:

14 seats



■ Parking

180 vehicles (free)



■ Remarks

Complex including the town's library, Children's Center, Tsubata Children's Science Museum and Lifelong Learning Center

■ 1F

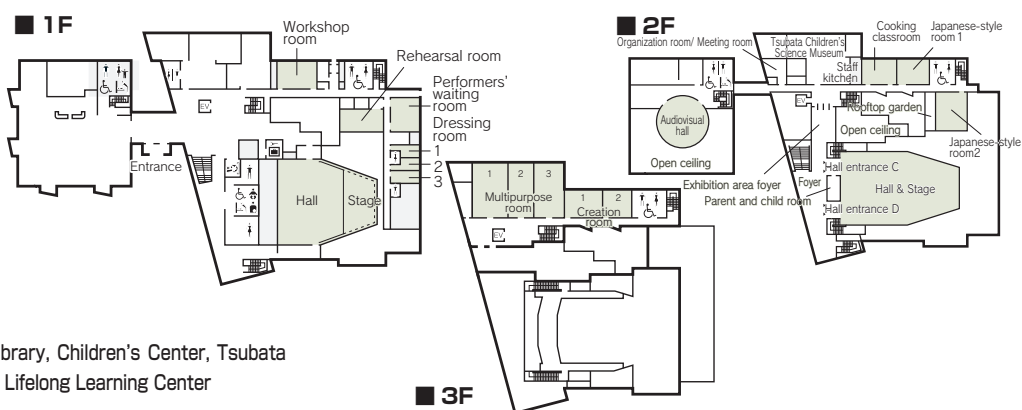

■ 3F

■ Convention site

| Site name | Floor | Area(m ²) | Width × Depth (m) | Ceiling height(m) | Capacity (persons) | | | | | Remarks |
|--------------------------|-------|-----------------------|-------------------|-------------------|--------------------|--------|---------|--------|--------|---|
| | | | | | Fixed seats | School | Theater | Seated | Buffet | |
| Hall | 1,2 | | 17.6 × 10.2 | 10.8 | 784 | — | — | — | — | Wheelchair space: 12, Parent and child room: 6 |
| Audiovisual hall | 2 | 76 | 15 × 15 | 7 | 150 | 150 | 150 | — | — | With a small stage, acoustic system and a lectern |
| Dressing room1 | 1 | 13 | 2.6 × 5 | 2.8 | — | — | — | 6 | 6 | Western-style room |
| Dressing room2 | 1 | 13 | 2.6 × 5 | 2.8 | — | — | — | 6 | 6 | Western-style room |
| Dressing room3 | 1 | 13 | 2.6 × 5 | 2.8 | — | — | — | 6 | 6 | Japanese-style room with shower |
| Rehearsal room | 1 | 83 | 7.5 × 11 | 2.8 | — | 18 | — | — | — | Noise insulation, upright piano, acoustic system |
| Performers' waiting room | 1 | 75 | 7 × 11 | 6 | — | 18 | — | — | — | Two mirror walls (with handrail), upright piano, acoustic system |
| Workshop room | 1 | 76 | 7.5 × 10 | 2.8 | — | 30 | — | — | — | |
| Japanese-style room 1 | 2 | 50 | 4.5 × 11 | 2.6 | — | 30 | 40 | — | — | |
| Japanese-style room 2 | 2 | 50 | 4.5 × 11 | 2.5 | — | 20 | — | — | — | Tea ceremony room with the preparation area and a Japanese garden |
| Cooking room | 2 | 73 | 7.3 × 10 | 2.8 | 36 | 36 | — | — | — | Gas cooking stove (6), IH cooking equipment (1), oven & microwave, rice cooker, etc. |
| Multipurpose room 1 | 3 | 140 | 9.3 × 13.6 | 4.8 | — | 40~60 | 100 | 60 | 100 | Multipurpose room 1~3 can be integrated into one space. Acoustic system are furnished in Multipurpose room 1. |
| Multipurpose room 2 | 3 | 100 | 6.8 × 13.6 | 4.8 | — | 30~45 | 80 | 60 | 80 | |
| Multipurpose room 3 | 3 | 100 | 7.3 × 13.6 | 4.8 | — | 28~42 | 80 | 60 | 80 | |
| Creation room 1 | 3 | 53 | 6.5 × 8 | 2.8 | 16 | 16 | — | — | — | Worktable for 4 persons: 4 |
| Creation room 2 | 3 | 53 | 6.5 × 8 | 2.8 | 24 | 24 | — | — | — | Worktable for 4 persons: 6, electric furnace, potter's wheel |

Width × Depth and the floor area may not match depending on the shape of the room.