

Tatsunokuchi Welfare Center, Nomi City

Nu-10 Tatsunokuchi-machi, Nomi 923-1245

TEL: 0761-51-4511 FAX: 0761-51-4533

URL: <http://www.nomi-furusato-kousha.jp/>



■ Number of seats

400 seats (Exchange hall)

200 seats (Multipurpose hall)

80 seats (Large seminar room)

■ Traffic access

- Take the bus for Tatsunokuchi Onsen (Kaga Hakusan bus) from JR/IR Komatsu Station, drive for 33 min, get off at the last stop, and walk for 5 min.
- Drive from Komatsu IC of Hokuriku Expressway toward Tatsunokuchi Hill Park for 12km along public highways and prefectural highways 54 and 22.

■ Hours

9:00am~10:00pm (Reception closes at 9:00pm)

Closed: the 2nd and 4th Mondays of each month and during the year-end and New Year holidays

■ Date to start accepting reservation

■ Accommodation

None

■ Restaurants/Cafés

Dining room: 30 seats

- Parking

100 vehicles (free)

■ Remarks

- The second floor is at the same level as the parking lot.
- Ask the facility regarding use of the seminar rooms.



Exchange hall

Floor plan

■ 2F

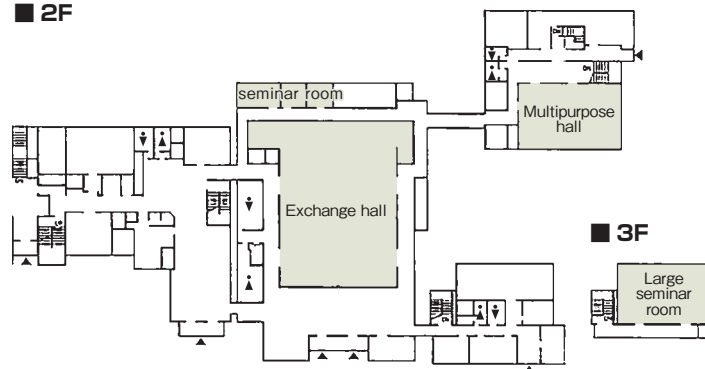

■ Convention site

[illegible]

Width x Depth and the floor area may not match depending on the shape of the room.