

Kaga Hyakumangoku

11-2-1 Yamashiro Onsen, Kaga, 922-0242

TEL: 0761-77-0200 FAX: 0761-77-0201

URL: <https://www.kaga-hyakumangoku.jp/>

E-mail: yoyaku@kaga-hyakumangoku.jp



Convention hall "Sakura"

Floor plan

■ 2F

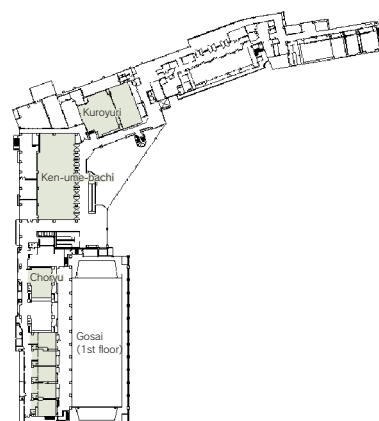

■ Number of seats

900 seats (Convention hall "Gosai" in theater style)



■ Traffic access

10-min drive from JR・IR Kaga Onsen Station
Free pickup bus is available (reservation required)



■ Hours

9:00am~10:00pm

■ Date to start accepting reservation

One year before the date of use



■ Accommodation

- Main building: 179 rooms (813 people)
- Annex: 45 rooms (210 people)



■ Restaurants/Cafés

- Restaurant "Umeno-an"
- Shop
- Karaoke room



■ Parking

- 200 vehicles
- 20 large buses



■ Remarks

27 large and small banquet rooms
Wi-Fi accessible

■ Convention site

Site name	Floor	Area(m ²)	Width × Depth (m)	Ceiling height(m)	Capacity (persons)					Remarks
					Fixed seats	School	Theater	Seated	Buffet	
Convention hall "Ken-ume-bachi"	2	560	16.5 × 36.5	3.4		500	800	250		The space can be partitioned into two rooms.
Convention hall "Sakura"	2	460	20.0 × 20.0	4.0		500	800	230		The space can be partitioned into two rooms.
Kikuzakura	1	240	9.0 × 26.0	3.5		120	180	80		The space can be partitioned into two rooms.
Gosai	1	1,000	21.6 × 41.5	5.0		700	900	600		The space can be partitioned into two rooms.
Kuroyuri	2	175	9.5 × 18.0	2.7		100	150	65		
Choryu	2	96	8.1 × 12.0	2.8		55	90	40		

Width × Depth and the floor area may not match depending on the shape of the room.