

# Nonoichi City Hall “forte”

Closed until March 31, 2025 for renovation work.  
(Large Hall is closed until April 30, 2025.)

5-4-1 Hon-machi, Nonoichi 921-8815

TEL: 076-248-8000 FAX: 076-246-2391

URL: <https://forte.nono1.jp/>

E-mail: [info@forte.nono1.jp](mailto:info@forte.nono1.jp)



■ Number of seats

**804** seats (Large hall)



■ Traffic access

30 min by bus from JR Kanazawa Station

(Get off at Taheiji and walk for 2 min.)

20 min by taxi from JR Kanazawa Station



■ Hours

9:00am~10:00pm

Closed: 1st and 3rd Wed., year-end and  
New Year's holidays (Dec. 28~Jan. 3)

■ Date to start accepting reservation

Beginning of the month one year before the date of  
use



■ Accommodation

None



■ Restaurants/Cafés

Coffee shop “forte HIMAWARI”: 20 seats



■ Parking

**250** vehicles (free)



■ Remarks

Dressing room: 3, Rehearsal room: 1



Large hall

## Floor plan

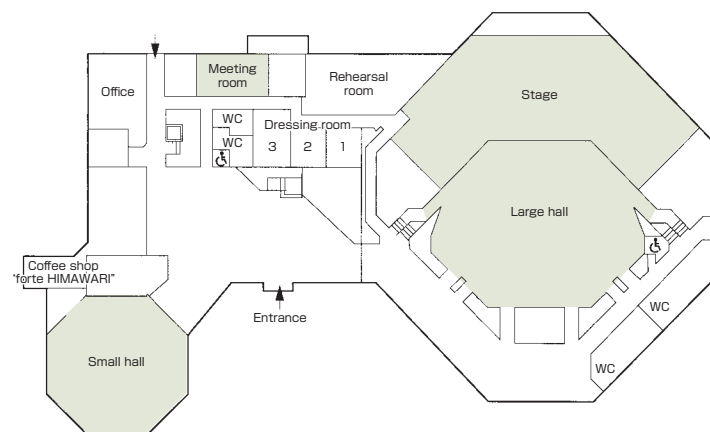

## ■ Convention site

Site name	Floor	Area(m <sup>2</sup> )	Width × Depth (m)	Ceiling height(m)	Capacity (persons)					Remarks
					Fixed seats	School	Theater	Seated	Buffet	
Large hall	1	700	—	—	804	—	—	—	—	1F: 682 seats, 2F: 122 seats
Small hall	1	326	—	5.3	—	150	300	—	—	
Meeting room	1	57	10.0 × 5.2	2.7	—	20	—	—	—	
Culture room	2	121	15.0 × 7.5	2.7	—	48	—	—	—	
Lecture room	2	56	7.5 × 7.5	2.7	—	20	—	—	—	
Japanese-style room	2	36-tatami-mat	10.2 × 5.0	2.5	—	—	—	—	—	Two 18-tatami-mat rooms adjacent to a tea-ceremony room (6-tatami-mat)
Seminar room	2	60	7.5 × 8.0	2.7	—	25	—	—	—	
Meeting room	2	36	3.8 × 8.0	2.7	—	12	—	—	—	

Width × Depth and the floor area may not match depending on the shape of the room.