

Yamanaka Onsen Bunka Kaikan

To-5-1 Nishikatsuragi-machi, Yamanaka Onsen, Kaga
922-0112

Tel: 0761-78-3311

Fax: 0761-78-3435



■ Number of seats

1,158 seats

(Large hall: One-floor type (Fixed seats: 458, Movable seats: 700))



■ Traffic access

20min by bus from JR Kaga Onsen Station
(Get off at Yamanaka Onsen and walk for 2 min.)

30-min drive from Komatsu Airport

20-min drive from Kaga IC of Hokuriku Expressway



■ Hours

9:00am~10:00pm

Closed: Year-end and New Year's holidays (Dec. 29~Jan. 3)

■ Date to start accepting reservation

Six months before the date of use



■ Accommodation

None



■ Restaurants/Cafés

None



■ Parking

30 vehicles (free)



■ Remarks

The Hotel Association, Tourism Association and Commerce and Industry Association are co-located within the building.

We can assist with a range of services, according to your needs, such as layout planning, site management, pickup bus arrangement (between JR Kaga Onsen Station/Komatsu Airport, conference venue, and hotels), and the preparation and cleaning of venues.

(Yamanaka Onsen Hotel Association: Tel: 0761-78-0330)



Large hall

Floor plan

■ 2F

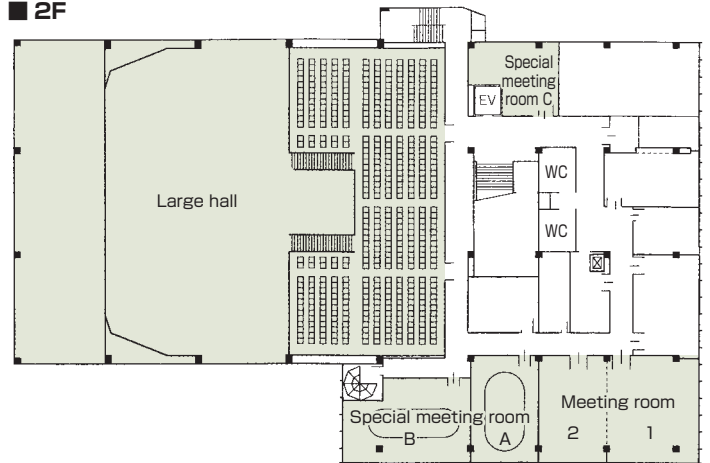

■ Convention site

Site name	Floor	Area(m ²)	Width × Depth (m)	Ceiling height(m)	Capacity (persons)					Remarks
					Fixed seats	School	Theater	Seated	Buffet	
Large hall	1・2	375.0	15.0 × 25.0	—	458	—	1158	—	—	1F: Movable seats: 700, 2F: Fixed seats: 458
Meeting room 1	2	79.9	8.9 × 9.0	2.6	—	50	—	—	—	
Meeting room 2	2	53.4	6.0 × 9.0	2.6	—	30	—	—	—	
Special meeting room A	2	53.2	6.0 × 9.2	2.6	20	—	—	—	—	Round table
Special meeting room B	2	63.0	10.8 × 7.1	2.6	26	—	—	—	—	Round table
Special meeting room C	2	39.2	—	2.6	—	20	—	—	—	

Width × Depth and the floor area may not match depending on the shape of the room.