

# Municipal Lyceum in Kaga "Come On a Hall"

2-68 Hokubu, Yamashiro Onsen, Kaga 922-0243

Tel: 0761-77-2811

Fax: 0761-77-5681

URL: <http://kaga-bunka.lolipop.jp>



Hall



■ Number of seats

**1,426** seats (Hall)  
(Six wheelchair spaces, 1,310 seats are available when the orchestra pit is used)



■ Traffic access

15-min drive from Kaga IC of Hokuriku Expressway  
15-min drive from Katayamazu IC of Hokuriku Expressway  
7 min by bus from JR Kaga Onsen Station  
(Get off at Bunka-kaikan-mae and walk for 2 min.)  
25 min by taxi from Komatsu Airport



■ Hours

9:00am~10:00pm  
Closed: Year-end and New Year's holidays (Dec. 29~Jan. 3), maintenance and inspection period

■ Date to start accepting reservation

Hall and meeting room: One year before the date of use  
Meeting room only: 6 months before the date of use



■ Accommodation

None



■ Restaurants/Cafés

- Tea ceremony room
- Coffee shop



■ Parking

**300** vehicles (free)



■ Remarks

None

## Floor plan

■ 1F

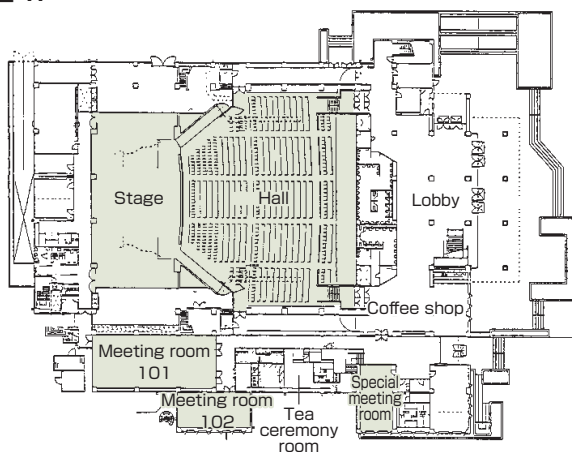

■ 2F

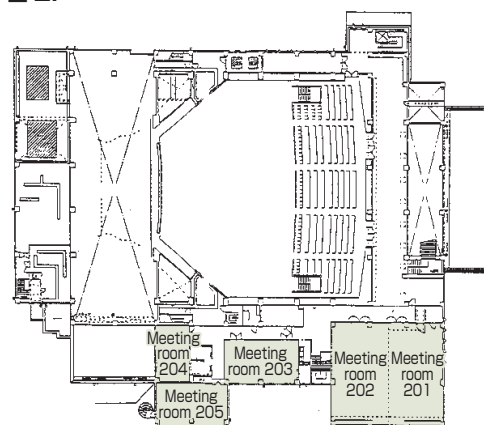

■ Convention site

Site name	Floor	Area(m <sup>2</sup> )	Width × Depth (m)	Ceiling height(m)	Capacity (persons)					Remarks
					Fixed seats	School	Theater	Seated	Buffet	
Hall	1	964	33.7 × 40.9	—	1,426	—	—	—	—	With an orchestra pit
Meeting room 101	1	162	18.5 × 8.5	2.7~3.2	—	108	144	—	—	
Meeting room 102	1	72	11.2 × 6.0	2.5~3.0	—	36	60	—	—	
Special meeting room	1	62	5.6 × 10.2	2.5	14	—	—	—	—	
Meeting room 201	2	131	8.4 × 14.5	2.9	—	90	150	—	—	} Combined use is possible.
Meeting room 202	2	131	8.4 × 14.5	2.9	—	90	150	—	—	
Meeting room 203	2	77	10.9 × 6.2	2.7~3.2	—	42	63	—	—	
Meeting room 204	2	48	5.4 × 8.5	2.5	—	24	—	—	—	
Meeting room 205	2	75	10.9 × 6.2	2.5	—	36	70	—	—	

Width × Depth and the floor area may not match depending on the shape of the room.