

# Terai District Public Hall

Yo-47 Terai-machi, Nomi 923-1121

Tel: 0761-57-0030

Fax: 0761-57-3709



Large hall



■ Number of seats

**500** seats (Large hall)



■ Traffic access

1 hr by bus from JR Kanazawa Station  
(Get off at Nomi Shiyakusho Terai Bunshitsu-mae and walk for one min.)



■ Hours

9:00am~9:30pm  
Closed: Monday, year-end and New Year's holidays  
(Dec. 28~Jan. 3)

■ Date to start accepting reservation

At any time



■ Accommodation

None



■ Restaurants/Cafés

• Coffee shop "Coco": 17 seats



■ Parking

**245** vehicles (free)  
The 133 vehicle parking lot is shared with Terai Gymnasium.  
The 89 vehicle parking lot is not used during the weekday daytime.



■ Remarks

None

## Floor plan

■ 1F

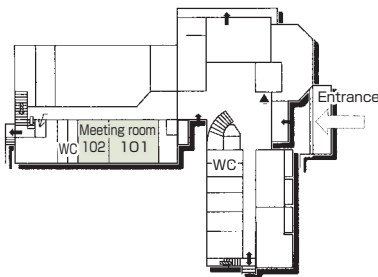

■ 2F

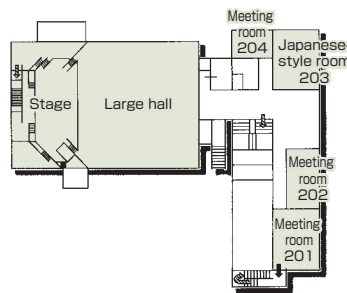

■ 3F

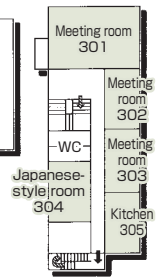

## ■ Convention site

Site name	Floor	Area(m <sup>2</sup> )	Width × Depth (m)	Ceiling height(m)	Capacity (persons)					Remarks
					Fixed seats	School	Theater	Seated	Buffet	
Meeting room 101	1	83.0			—	36	—	—	—	
Meeting room 102	1	49.8			—	24	—	—	—	
Meeting room 201	2	80.0			—	20	—	—	—	
Meeting room 202	2	58.0			—	24	—	—	—	
Japanese-style room 203	2	40-tatami-mat			—	—	—	—	—	
Meeting room 204	2	35.0			—	18	—	—	—	
Large hall	2	451.5			—	120	500	—	—	
Meeting room 301	3	150.0			—	36	64	—	—	
Meeting room 302	3	58.0			—	24	—	—	—	
Meeting room 303	3	58.0			—	30	—	—	—	
Japanese-style room 304	3	25-tatami-mat			—	—	—	—	—	
Kitchen 305	3	58.0			—	30	—	—	—	

Width × Depth and the floor area may not match depending on the shape of the room.