

# Nonoichi City Hall "forte"

5-4-1 Hon-machi, Nonoichi 921-8815  
 Tel: 076-248-8000  
 Fax: 076-246-2391  
 URL: <http://forte.nono1.jp>  
 E-mail: [info@forte.nono1.jp](mailto:info@forte.nono1.jp)



Large hall



■ Number of seats  
**804** seats (Large hall)



■ Traffic access  
 30 min by bus from JR Kanazawa Station  
 (Get off at Taheiji and walk for 2 min.)  
 20 min by taxi from JR Kanazawa Station



■ Hours  
 9:00am~10:00pm  
 Closed: 1st and 3rd Wed., year-end and  
 New Year's holidays (Dec. 28~Jan. 3)

■ Date to start accepting reservation  
 Beginning of the month one year before the date of  
 use



■ Accommodation  
 None



■ Restaurants/Cafés  
 • Coffee shop "forte HIMAWARI": 20 seats



■ Parking  
**250** vehicles (free)



■ Remarks  
 Dressing room: 3, Rehearsal room:1

## Floor plan

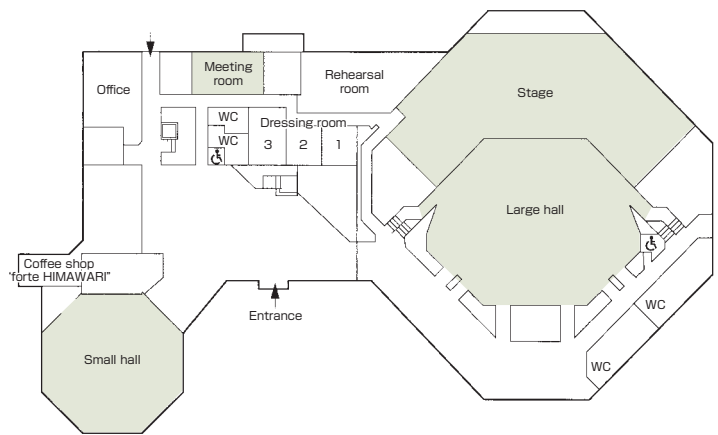

### ■ Convention site

Site name	Floor	Area(m <sup>2</sup> )	Width × Depth (m) (m)	Ceiling height(m)	Capacity (persons)					Remarks
					Fixed seats	School	Theater	Seated	Buffet	
Large hall	1	700	—	—	804	—	—	—	—	1F: 682 seats, 2F: 122 seats
Small hall	1	326	—	5.3	—	150	300	—	—	
Meeting room	1	57	10.0 × 5.2	2.7	—	20	—	—	—	
Culture room	2	121	15.0 × 7.5	2.7	—	48	—	—	—	
Lecture room	2	56	7.5 × 7.5	2.7	—	20	—	—	—	
Japanese-style room	2	36-tatami-mat	10.2 × 5.0	2.5	—	—	—	—	—	Two 18-tatami-mat rooms adjacent to a tea-ceremony room (6-tatami-mat)
Seminar room	2	60	7.5 × 8.0	2.7	—	25	—	—	—	
Conference room	2	36	3.8 × 8.0	2.7	—	12	—	—	—	

Width × Depth and the floor area may not match depending on the shape of the room.