

38 TKP Kanazawa Conference Center

APA Kanazawa Bldg. 1-33 Kamitsutsumi-cho, Kanazawa
 920-0869
 Tel: 076-231-1160 Fax: 076-260-6260
<http://tkpkanazawa.net/>



Meeting room



■ Number of seats
18 ~ 183 seats



■ Traffic access
 3-min bus ride from JR Kanazawa Station
 (Get off at Musashigatsuji and walk for 3 min.)
 15-min walk from JR Kanazawa Station



■ Hours
 8:00am~11:00pm

■ Date to start accepting reservation
 Beginning of the month one year before the date of use



■ Accommodation
 None



■ Restaurants/Cafés
 None



■ Parking
 None



■ Remarks
 Arrangement of equipment
 Receipt and sending of packages
 No need to set up the site and return it to its original state
 Catering arrangements
 Lunch boxes, drinks, arrangement of post-conference party
 *Rental for party only is possible.
 Accommodation can be arranged.
 Reservations: 080-4442-9627 (Yamashita)

Floor plan

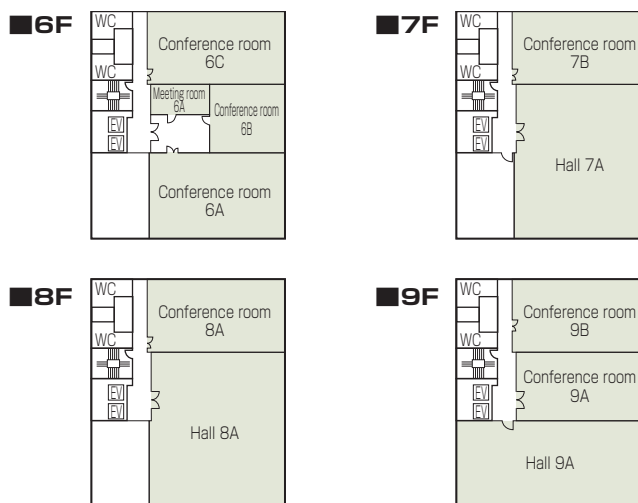

■ Convention site

Site name	Floor	Area (㎡)	Ceiling height (m)	Capacity (persons)							Remarks
				Theater	School	Island	T-shaped island	Square-shaped	Seated	Standing	
Conference room 6A	6	137.9	2.46	-	99	-	-	-	-	-	A podium and a whiteboard are permanently installed.
Conference room 6B	6	62.6	2.46	-	36	-	-	-	-	-	
Conference room 6C	6	116.2	2.46	-	99	-	-	-	-	-	
Meeting room 6A	6	23.8	2.46	-	-	-	-	18	-	-	
Hall 7A	7	245.1	2.5	-	183	-	-	-	-	-	
Conference room 7B	7	119.8	2.5	-	99	-	-	-	-	-	
Hall 8A	8	234.6	2.46	-	183	-	-	-	-	-	
Conference room 8A	8	121.4	2.5	-	99	-	-	-	-	-	
Hall 9A	9	199.8	2.5	-	138	-	-	-	-	-	
Conference room 9A	9	110.6	2.5	-	90	-	-	-	-	-	
Conference room 9B	9	119.8	2.5	-	99	-	-	-	-	-	

Width × Depth and the floor area may differ depending on the shape of the room.