

2 Shiinoki Cultural Complex, Ishikawa Prefecture

2-1-1 Hirosaka, Kanazawa 920-0962
 Tel: 076-261-1111 Fax: 076-261-1115
 URL <http://www.shiinoki-geihinkan.jp>



Garden Room



Event Hall



Seminar Room A



Seminar Room B



■ Number of seats
90 seats (Garden Room)



■ Traffic access
 10-min bus ride from JR Kanazawa Station
 (Get off at Korinbo ATRIO-mae and walk 5 min.),
 10 min by taxi from JR Kanazawa Station



■ Hours
 9:00 am ~ 10:00 pm (Differs depending on the
 restaurant or shop)
 Closed: Year-end and New Year's holidays (Dec.
 29~Jan. 3)

■ Date to start accepting reservation
 Six months before the date of use



■ Accommodation
 None



■ Restaurants/Cafés
 Café & Brasserie Paul Bocuse (42 seats)
 Restaurant "Jardin Paul Bocuse" (100 seats)



■ Parking
95 vehicles (pay)



■ Remarks
 None

Floor plan

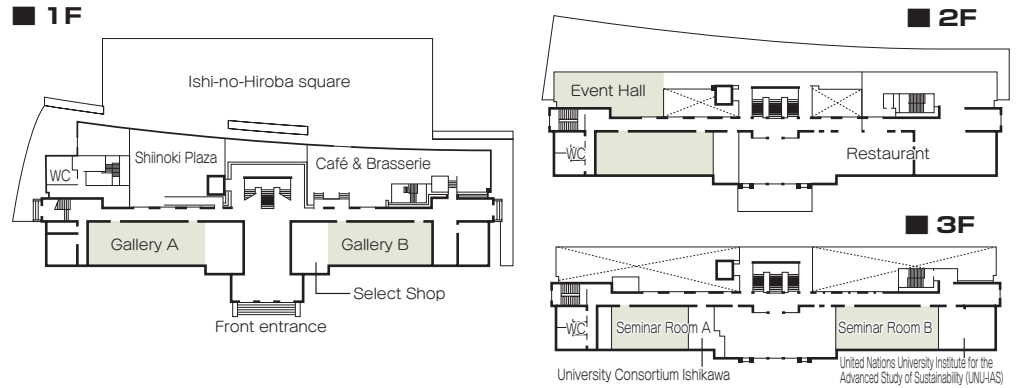

■ Convention site

Site name	Floor	Area (㎡)	Width×Depth (m) (m)	Ceiling height (m)	Capacity (persons)					Remarks
					Fixed seats	School	Theater	Seated	Buffet	
Garden Room	2	130	7.2×18.2	2.8	—	90	—	—	—	The space can be partitioned into two rooms.
Seminar Room A	3	100	7.2×13.6	3.5	—	40	—	—	—	The space can be partitioned into two rooms.
Seminar Room B	3	130	7.2×18.2	3.5	—	70	—	—	—	The space can be partitioned into two rooms.
Event Hall	2	140	—	7	—	—	—	—	—	
Gallery A	1	130	7.2×18.2	2.8	—	—	—	—	—	
Gallery B	1	100	7.2×13.6	2.8	—	—	—	—	—	

Width × Depth and the floor area may differ depending on the shape of the room.