

# 13 Ishikawa Kyoiku Kaikan

1-2-40 Korinbo, Kanazawa 920-0961  
 Tel: 076-222-1241 Fax: 076-222-1242  
 URL <https://kyoiku-kaikan.com/>



■ Number of seats  
**344** seats (Hall)



■ Traffic access  
 15-min bus ride from JR Kanazawa Station  
 (Get off at Korinbo and walk for 2 min.)  
 12 min by taxi from JR Kanazawa Station



■ Hours  
 9:00am~9:00pm

■ Date to start accepting reservation  
 One year before the date of use



■ Accommodation  
 None



■ Restaurants/Cafés  
 Tea Room & Bar Potchan (17 seats)



■ Parking  
 None



■ Remarks  
 None



Hall



Meeting room 1

## Floor plan

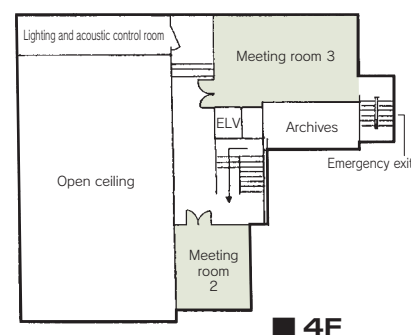
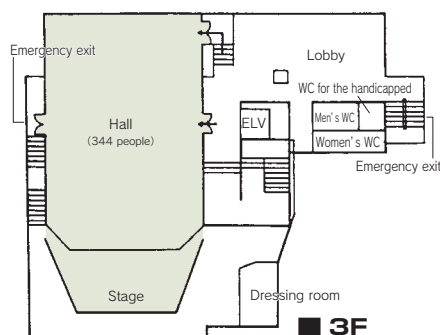
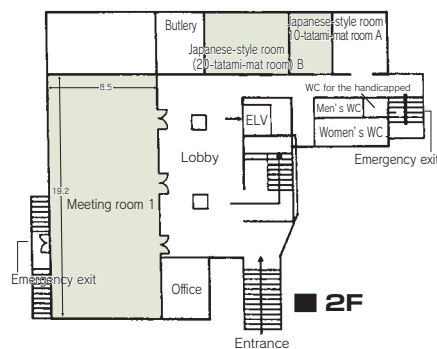

## ■ Convention site

| Site name               | Floor | Area (㎡)           | Width×Depth (m)(m) | Ceiling height (m) | Capacity (persons) |        |         |        | Remarks |                      |
|-------------------------|-------|--------------------|--------------------|--------------------|--------------------|--------|---------|--------|---------|----------------------|
|                         |       |                    |                    |                    | Fixed seats        | School | Theater | Seated |         | Buffet               |
| Hall                    | 3     | 243                | —                  | —                  | 344                | —      | —       | —      | —       | Stage 58 ㎡(10.8×5.4) |
| Meeting room 1          | 2     | 163                | 8.5×19.2           | 2.8                | —                  | 80     | 150     | —      | —       |                      |
| Meeting room 2          | 4     | 49                 | 6.2× 7.9           | 2.5                | 16                 | —      | —       | —      | —       |                      |
| Meeting room 3          | 4     | 54                 | 11.6× 4.6          | 2.5                | 20                 | —      | —       | —      | —       |                      |
| Japanese-style room (A) | 2     | 10-tatami-mat room | 3.9× 3.3           | 2.3                | —                  | 10     | —       | —      | —       |                      |
| Japanese-style room (B) | 2     | 20-tatami-mat room | 3.9× 7.0           | 2.3                | —                  | 15     | —       | —      | —       |                      |
|                         |       |                    |                    |                    |                    |        |         |        |         |                      |
|                         |       |                    |                    |                    |                    |        |         |        |         |                      |
|                         |       |                    |                    |                    |                    |        |         |        |         |                      |
|                         |       |                    |                    |                    |                    |        |         |        |         |                      |

Width × Depth and the floor area may differ depending on the shape of the room.