

8 Kanazawa Bunka Hall

15-1 Takaoka-machi, Kanazawa 920-0864
 Tel: 076-223-1221 Fax: 076-223-1299
 URL <http://www.bunka-h.gr.jp>



■ Number of seats
899 seats (Hall) , Orchestra pit 59m²



■ Traffic access
 15-min bus ride from JR Kanazawa Station (Get off at Minami-cho/Oyama Shrine and walk for 3 min.)
 10 min by taxi from JR Kanazawa Station



■ Hours
 9:00am~10:00pm
 Closed: 2nd and 4th Wed. of the month
 (Days may change depending on events.)
 Year-end and New Year's holidays (Dec. 29~Jan. 3)

■ Date to start accepting reservation
 Beginning of the month one year before the date of use



■ Accommodation
 None



■ Restaurants/Cafés
 Restaurant/Café (open pending)



■ Parking
 None



■ Remarks
 Japanese Tearoom "Kansei-an"
 7 green rooms, 4 practice rooms
 Gallery



Concert Hall



Multipurpose room

■ Convention site

| Site name | Floor | Area (m ²) | Width×Depth (m) (m) | Ceiling height (m) | Capacity (persons) | | | | | Remarks |
|--|-------|------------------------|---------------------|--------------------|--------------------|--------|---------|--------|--------|--|
| | | | | | Fixed seats | School | Theater | Seated | Buffet | |
| Concert Hall | — | 868 | — | — | 899 | — | — | | | 1st floor: 800 seats, 2nd-floor: 99 seats, 4 wheelchair spaces |
| Assembly Room (Entire space) | 2 | 440 | 14.3×31.3 | 2.3~3.3 | — | 160 | 400 | | | |
| Assembly Room (Area 1) | 2 | 273 | 14.3×19.5 | 2.3~3.3 | — | 88 | 220 | | | |
| Assembly Room (Area 2) | 2 | 167 | 14.3×11.4 | 2.3~3.3 | — | 48 | 130 | | | |
| Conference Room 1 | 2 | 31 | 5.2×6.0 | 2.6 | 12 | — | — | | | Oval-shaped table |
| Conference Room 2 | 2 | 48 | 5.2×9.4 | 2.6 | 20 | — | — | | | Oval-shaped table |
| Conference Room 3 | 3 | 31 | 5.2×6.0 | 2.4 | — | 14 | — | | | |
| Conference Room 4 | 3 | 47 | 5.2×9.0 | 2.4 | 8 | — | — | | | Lounge suite |
| Conference Room 5 | 3 | 64 | 5.6×11.4 | 2.4 | — | 30 | — | | | Two rooms can be joined for use as one room. |
| Conference Room 6 | 3 | 64 | 5.6×11.4 | 2.4 | — | 30 | — | | | |
| Large Conference Room (incl. Waiting Area) | 3 | 350 | — | 2.8~3.8 | — | 99 | 210 | | | |
| Lounge | 3 | 36 | 5.5×6.5 | 2.4 | 12 | — | — | | | Oval-shaped table |
| Japanese Tearoom | 1 | 131 | — | — | — | — | — | | | 4.5-tatami-mat tearoom, 11-tatami-mat tearoom, chair seating tearoom |
| Gallery | 1 | 300 | — | 2.6~3.1 | — | — | — | | | |
| Multipurpose room | 1 | 87 | — | 2.6 | — | 36 | 60 | | | |

Width × Depth and the floor area may differ depending on the shape of the room.

Floor plan

■ 1F

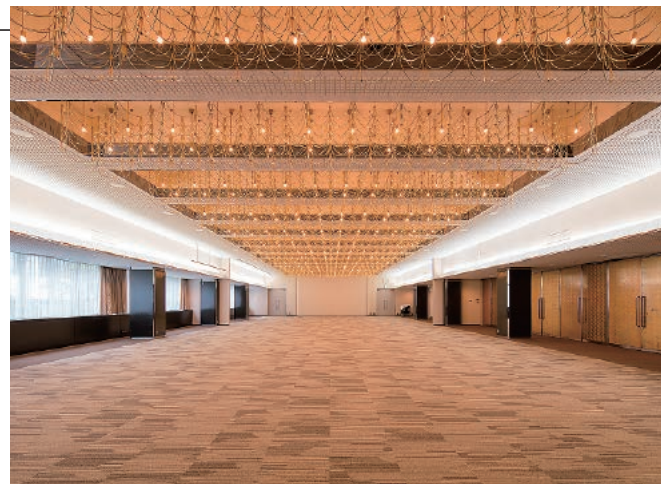
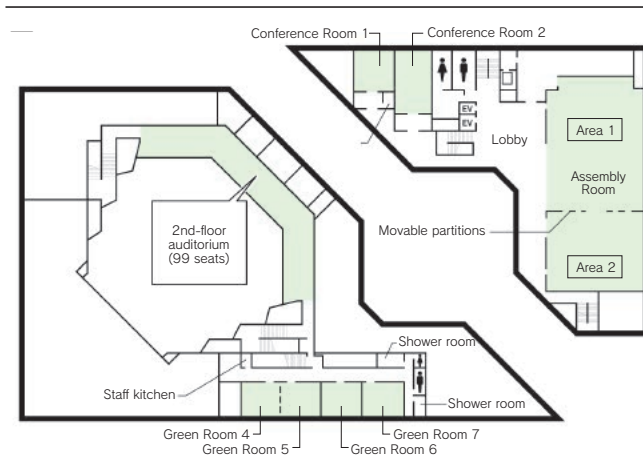
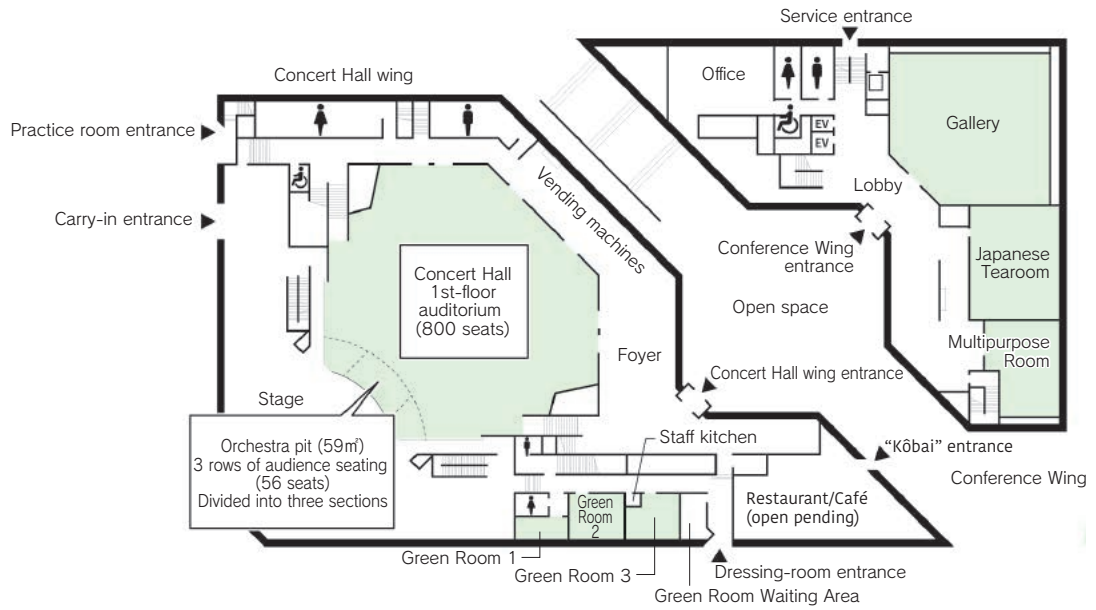

Assembly Room

■ 3F

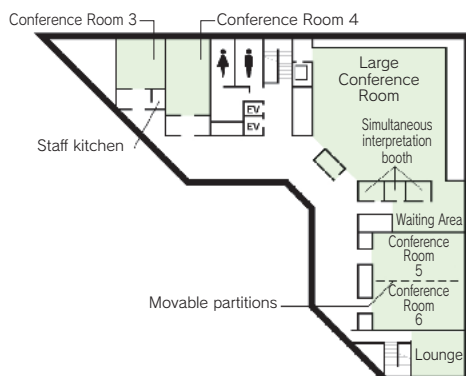

Large Conference Room