

# 4 Hondanomori Hall

4-17-1 Ishibiki, Kanazawa 920-0935  
 Tel: 076-222-0011 Fax: 076-222-1358  
 URL <http://www.hondanomori-hall.com>



Hall



■ Number of seats  
**1,707** seats (3 wheelchair spaces)



■ Traffic access  
 20-min bus ride from JR Kanazawa Station  
 (Get off at Dewa-machi and walk for 3 min.)  
 15 min by taxi from JR Kanazawa Station



■ Hours  
 9:00am~ 10:00pm  
 Closed: Weekends and holidays  
 (unless there is an event)

## Floor plan

■ Date to start accepting reservation  
 Beginning of the month one year before  
 the date of use



■ Accommodation  
 None



■ Restaurants/Cafés  
 Shop, Vending machines



■ Parking  
 Prefectural parking: **370** vehicles  
 (pay)



■ Remarks  
 25 vehicles for organizers  
 (free)

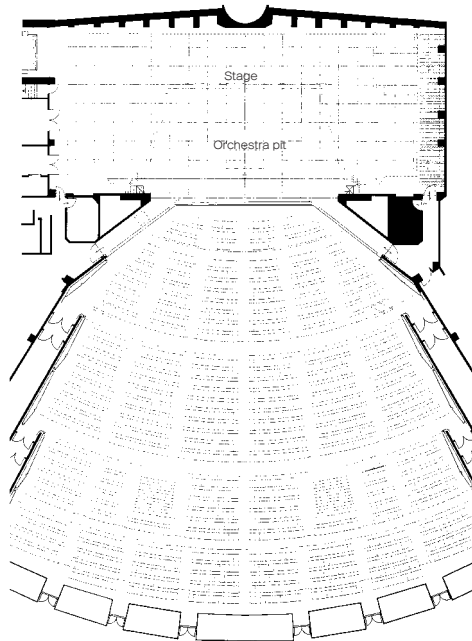

Floor plan of the auditorium

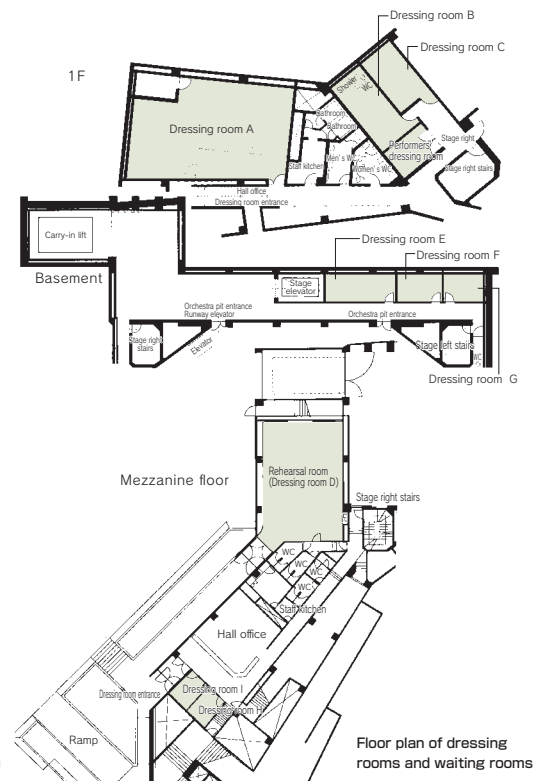

Floor plan of dressing rooms and waiting rooms

## ■ Convention site

Site name	Floor	Area (㎡)	Width×Depth (m)(m)	Ceiling height (m)	Capacity (persons)				Remarks	
					Fixed seats	School	Theater	Seated		Buffet
Hall	—	1,421	—	—	1,707	—	—	—	—	
Dressing room A	1	96	—	—	—	—	—	—	—	Partitioned into two rooms. With a bathroom
Dressing room B	1	19.5	—	—	—	—	—	—	—	
Dressing room C	1	15	—	—	—	—	—	—	—	
Performers' dressing room	1	9.7	—	—	—	—	—	—	—	
Dressing room E	Basement	19.5	—	—	—	—	—	—	—	
Dressing room F	Basement	12.6	—	—	—	—	—	—	—	
Dressing room G	Basement	11.2	—	—	—	—	—	—	—	
Rehearsal room (Dressing room D)	Mezzanine floor	99	—	—	—	—	—	—	—	
Dressing room H	Mezzanine floor	9.3	—	—	—	—	—	—	—	} Can be used as one room
Dressing room I	Mezzanine floor	8.4	—	—	—	—	—	—	—	

Width × Depth and the floor area may differ depending on the shape of the room.